

Recommended Applications:

- OEMS
- Chemical Wet Processing
- Spray Rinse Pumping
- Wet Processing
- Stand-by Pumping
- Recirculating Pumping
- Fume Scrubbing
- Waste Treatment
- Filtering
- Water Treatment
- Plating/Etching
- Pump Stations
- Transfer Pumping
- Photographic/ X-ray

Features:

- Self-priming when immersed in solution.
- In-tank mounted
- PTFE vapor seal
- Motor stand-off
- Handles solids up to 1/8" diameter
- Added strength of stainless steel



P1/3 thru P2



P3 thru P15

Penguin Series PSS 316 stainless steel vertical in-tank pumps are compact and simple in design, having only one moving part, yet highly efficient with proven performance. These general corrosion-resistant all purpose pumps are ideal for many OEM wet processing applications. Whether you are pumping cleaners, caustics, salt solutions, chlorinated solvents, photographic chemicals, deionized water, fatty, phosphoric, citric, or lactic acids, we can pump it with confidence.

Maximum temperature ratings are primarily dependent on the elastomer employed and the vapor pressure of the liquid being pumped. Operations temperature range is -30 degrees F to 211 degrees F. Temperatures greater than 211 degrees but less than 250 degrees F are acceptable for non-caustic, non-hydrocarbons service and are primarily dependent on the elastomer employed and the vapor pressure of the liquid being pumped. These pumps are designed for in-tank mounting only and have limited dry-run capability.

These 316 stainless steel vertical pumps utilize a replaceable coupled shaft using multiple set screws to minimize shaft deflection and misalignment associated problems while allowing the use of standard NEMA motors, which are readily available at most local motor suppliers, thus saving prolonged downtime and money. Standard elastomers are EPDM. Optional Viton and PTFE elastomers are also available. An optional motor stand-off and PTFE slinger/disk provide optimum bottom motor bearing protection against chemical fume corrosiveness. Single phase motors are wired for 115 volt using a 6 ft cord and grounding plug or for 230 volt using a 6 ft cord w/o plug. All 3 phase motors are shipped unwired, whereby the direction of motor rotation must be determined by the end user prior to operation.

P1/3

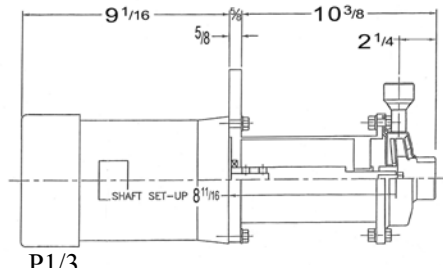
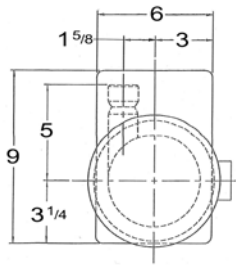
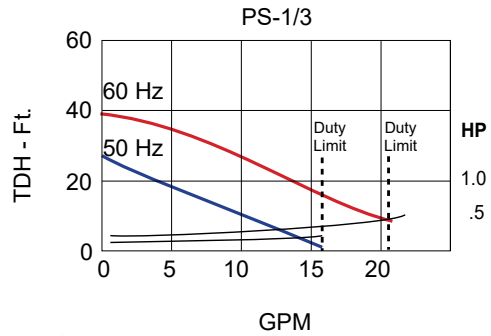

P1/3

P1/2S

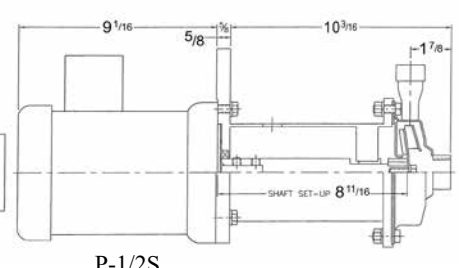
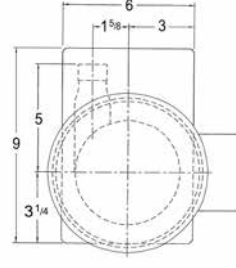
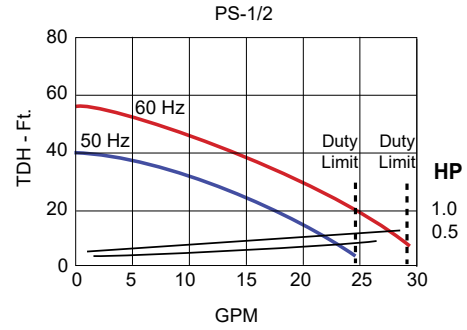

P1/2S

P3/4S

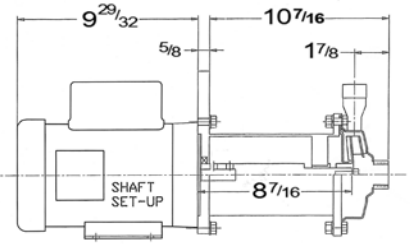
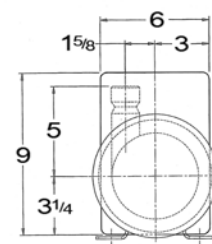
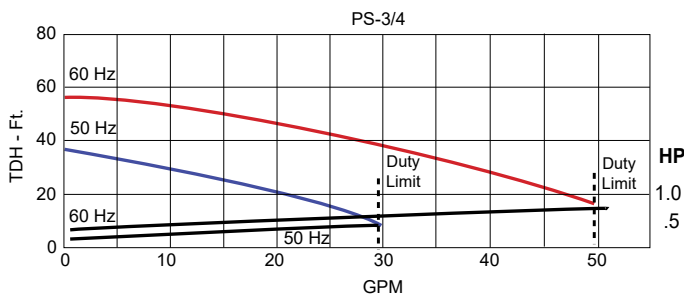

P-3/4S

P1S

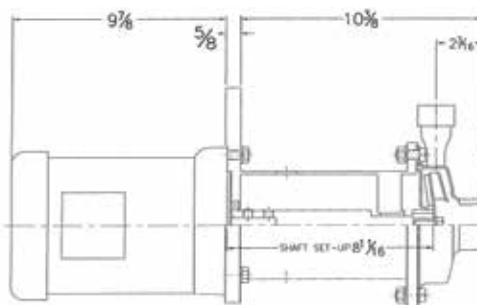
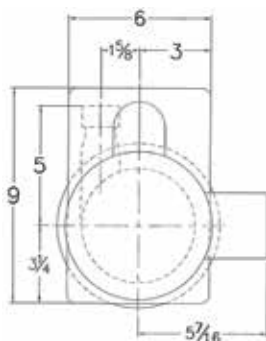
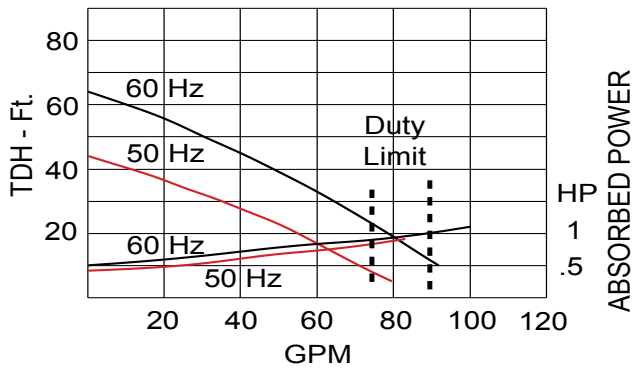

P-1S & 1-1/2S

P1-1/2S

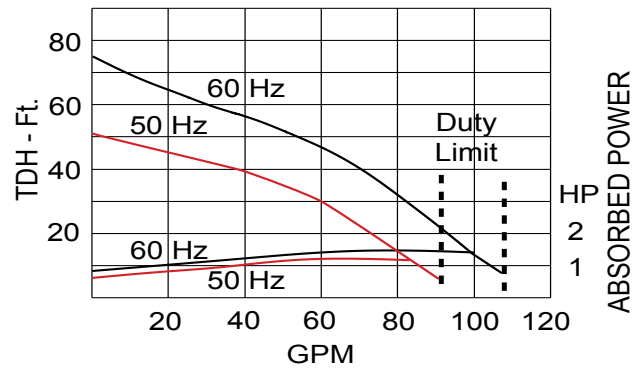

P2S

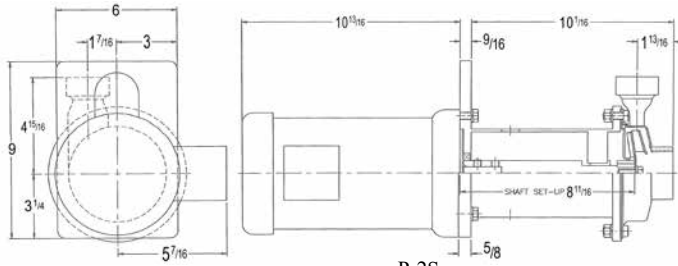
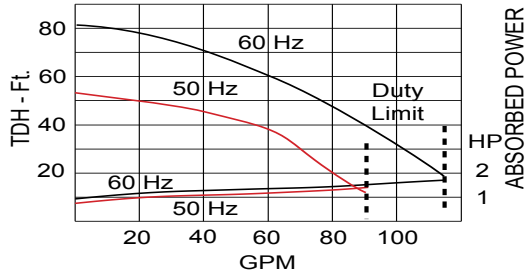

P-2S

P3S

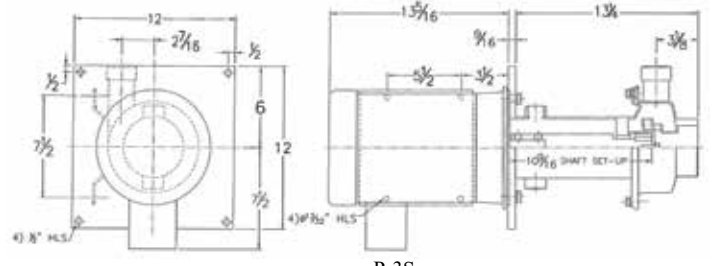
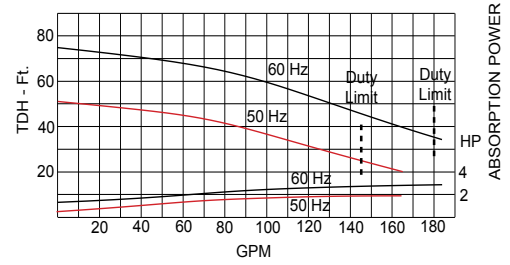

P-3S

P-5S

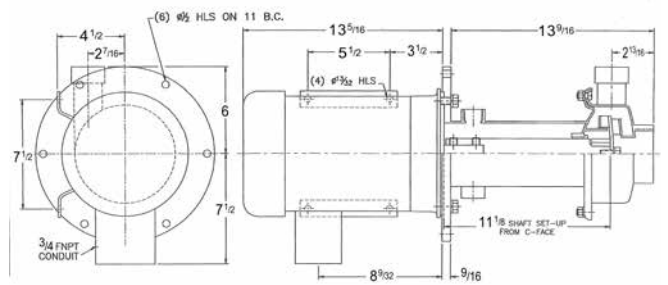
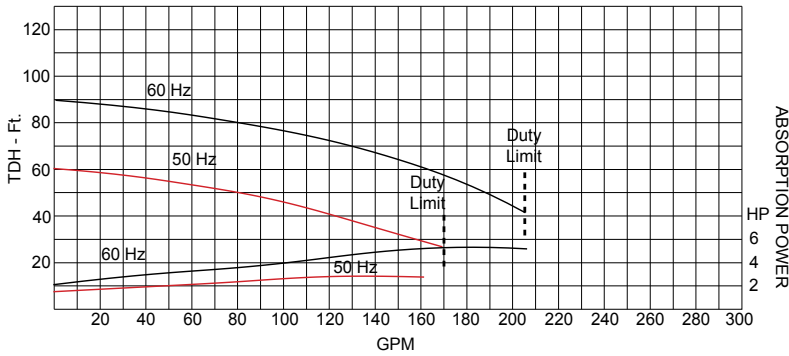

P-5S

P-7-1/2S

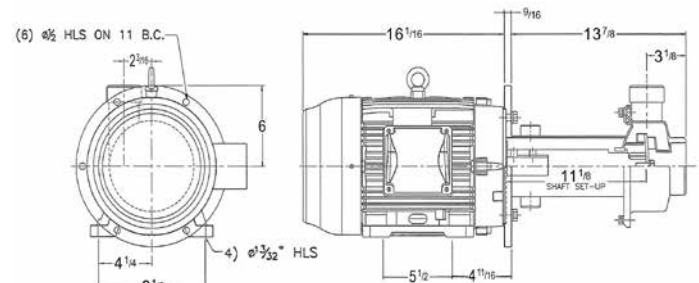
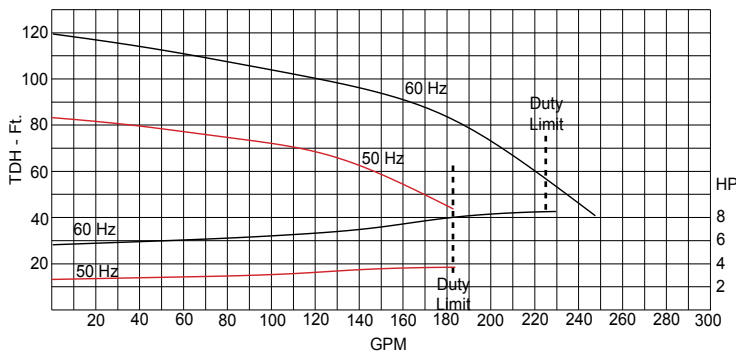

P-7-1/2S

P-10S

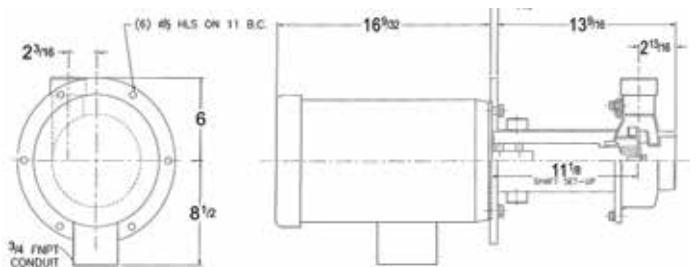
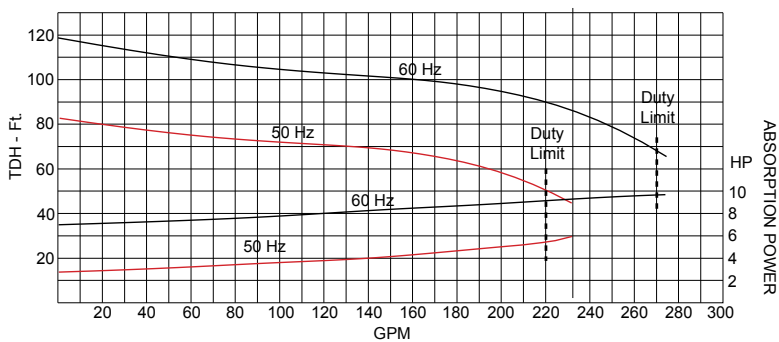

P-10S

P-15S

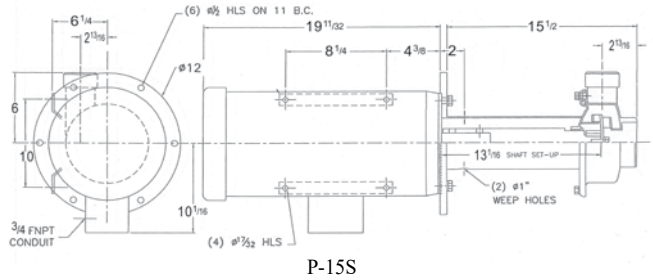
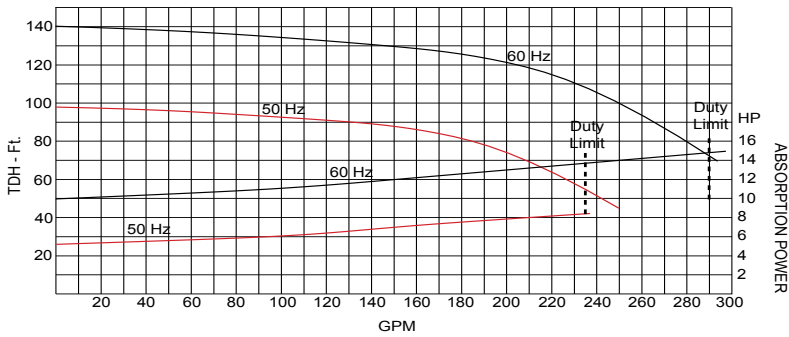

Specifications

Model	Max Flow (gpm)	Max Head (ft)	Suction	Discharge	Motor						Dimensions			
					HP	RPM	Volts	Hertz	Phase	Amps	Ht	Wth	Lth	Wt
P-1/3S	29	50	3/4" FPT	1/2" FPT	1/3	3450	115/230	60	1	7.8/3.9	11	11	26	55
P-1/2S			1" FPT	3/4" FPT	1/2	3450	115/230	60	1	7.8/3.9				55
P-3/4S	62	45	3/4" FPT	1/2" FPT	3/4	3450	208-230/460	50/60	3	9.8/4.9				59
P-3/4S			1" FPT	3/4" FPT						10/5				60
P-1S	86	64	1 1/2" FPT	1" FPT	1	3450	208-230/460	50/60	3	11/5.5				65
P-1 1/2S	100	70								1 1/2				115/230
P-2S	110	81	2" FPT	1 1/2" FPT	2	3450/2850	208-230/460	50/60	3	3.4-3.2/1.6				63
P-3S	175	70								3				115/230
P-5S	200	85	3" FPT	1 1/2" FPT	5	208-230/460	50/60	3	3	4.9-4.6/2.3				69
P-7 1/2S	225	108								7 1/2				115/230
P-7 1/2S			3" FPT	2" FPT	10	3450	230/460	60	3	8.2-7.8/3.9	140			
P-10S	270	120								10	12.2-11.6/5.8	160		
P-15S	290	150								20.5-19.0/9.5	180			
										25/12.5	200			
										34/17	225			

Nomenclature

PSS	-	1/2	-	S	-	V	-	P
Penguin Vertical Stainless Steel Pump		Horse Power		Construction Material		Elastomer Material		Bushing Material
		1/3=1/3 1/2=1/2 3/4=3/4 1=1 1-1/2= 1-1/2 2=2 3=3 5=5 7 1/2=7 1/2 10=10 15=15		S = 316SS		E = EPR V=VITON		P = PTFE